

**LEGEND**

[Red dashed line]	EXTENT OF WORKS
[Purple hatched]	PAVEMENT TYPE P1
[Green hatched]	PAVEMENT TYPE P1-V
[Yellow hatched]	PAVEMENT TYPE P2
[Blue hatched]	PAVEMENT TYPE P2-V
[Red hatched]	PAVEMENT TYPE P4
[Light blue hatched]	PAVEMENT TYPE RS1
[Light green hatched]	PAVEMENT TYPE RS2
[Light purple hatched]	PAVEMENT TYPE RS2A
[Light blue hatched]	PAVEMENT TYPE RS3
[Dark blue hatched]	PAVEMENT TYPE RS3-V
[Dark purple hatched]	PAVEMENT MILL AND RESHEET

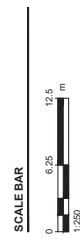

ISSUE/REVISION

NO.	DATE	DESCRIPTION
D	02/07/2020	ISSUED FOR CONSTRUCTION
C	01/05/2020	NOT ISSUED
B	01/05/2020	RE-ISSUE FOR TENDER
A	12/11/2019	ISSUE FOR TENDER
IR	DATE	DESCRIPTION

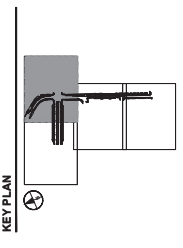

PROJECT NUMBER  
60300384

SHEET TITLE  
PACKAGE 2 A  
PAVEMENT PLAN

SHEET 2

SHEET NUMBER  
60300384-SHT-02-02-G-0302

REV  
D

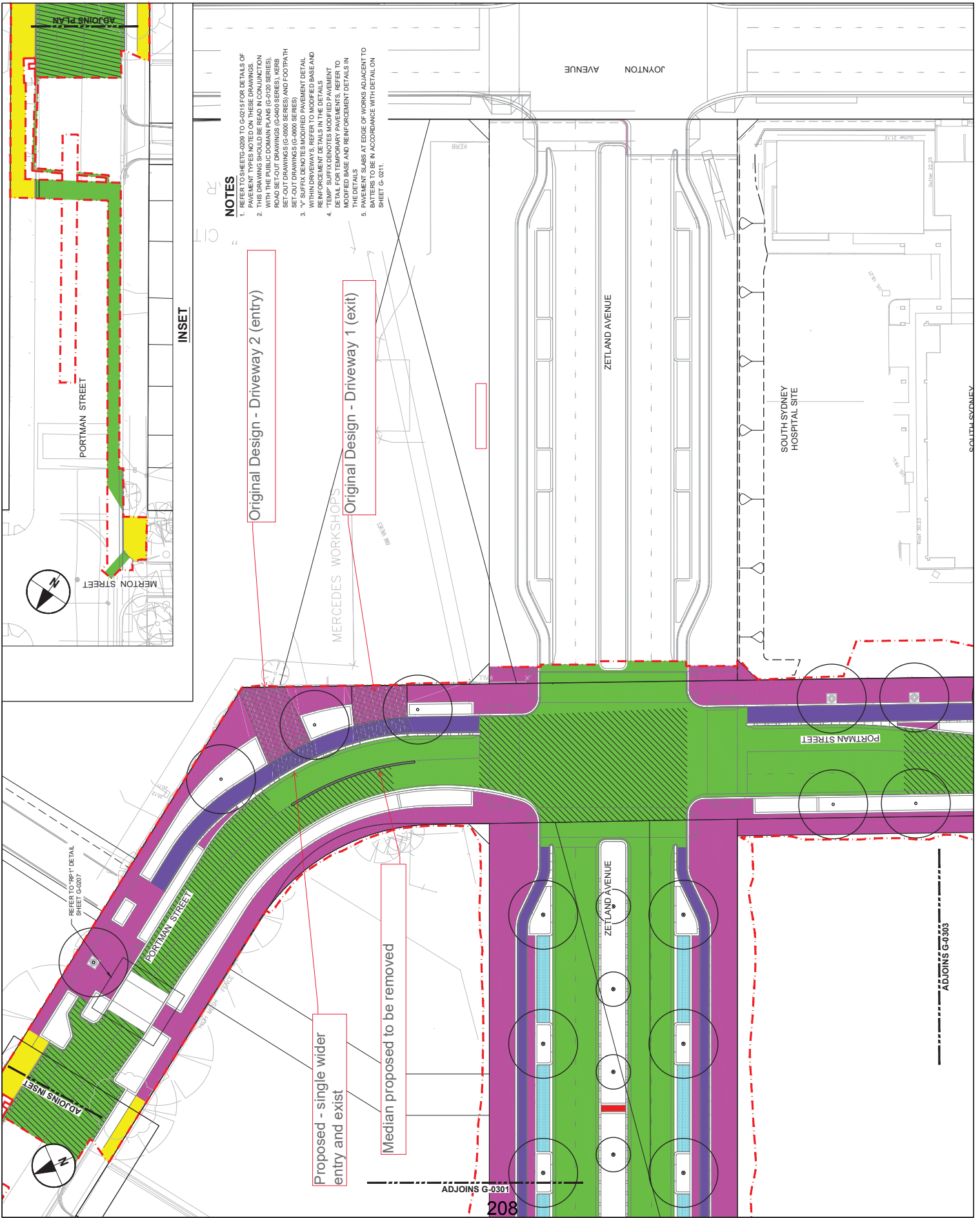

- NOTES**
- REFER TO SHEETS G-020 TO G-0216 FOR DETAILS OF PAVEMENT TYPES NOTED ON THESE DRAWINGS
  - THIS DRAWING SHOULD BE READ IN CONJUNCTION WITH THE PUBLIC DOMAIN PLANS (G-0170 SERIES), ROAD SET-OUT DRAWINGS (G-0400 SERIES), KERB SET-OUT DRAWINGS (G-0500 SERIES) AND FOOTPATH SET-OUT DRAWINGS (G-0600 SERIES) AND FOOTPATH SET-OUT DRAWINGS (G-0700 SERIES)
  - FOR OTHER DETAILS REFER TO THE RELEVANT DETAIL WITHIN DRAWINGS. REFER TO MODIFIED BASE AND REINFORCEMENT DETAILS IN THE DETAILS
  - 'TEMP' SUFFIX DENOTES MODIFIED PAVEMENT DETAIL FOR TEMPORARY PAVEMENTS. REFER TO MODIFIED BASE AND REINFORCEMENT DETAILS IN THE DETAILS
  - PAVEMENT SLABS AT EDGE OF WORKS ADJACENT TO BATTERS TO BE IN ACCORDANCE WITH DETAIL ON SHEET G-0211.